

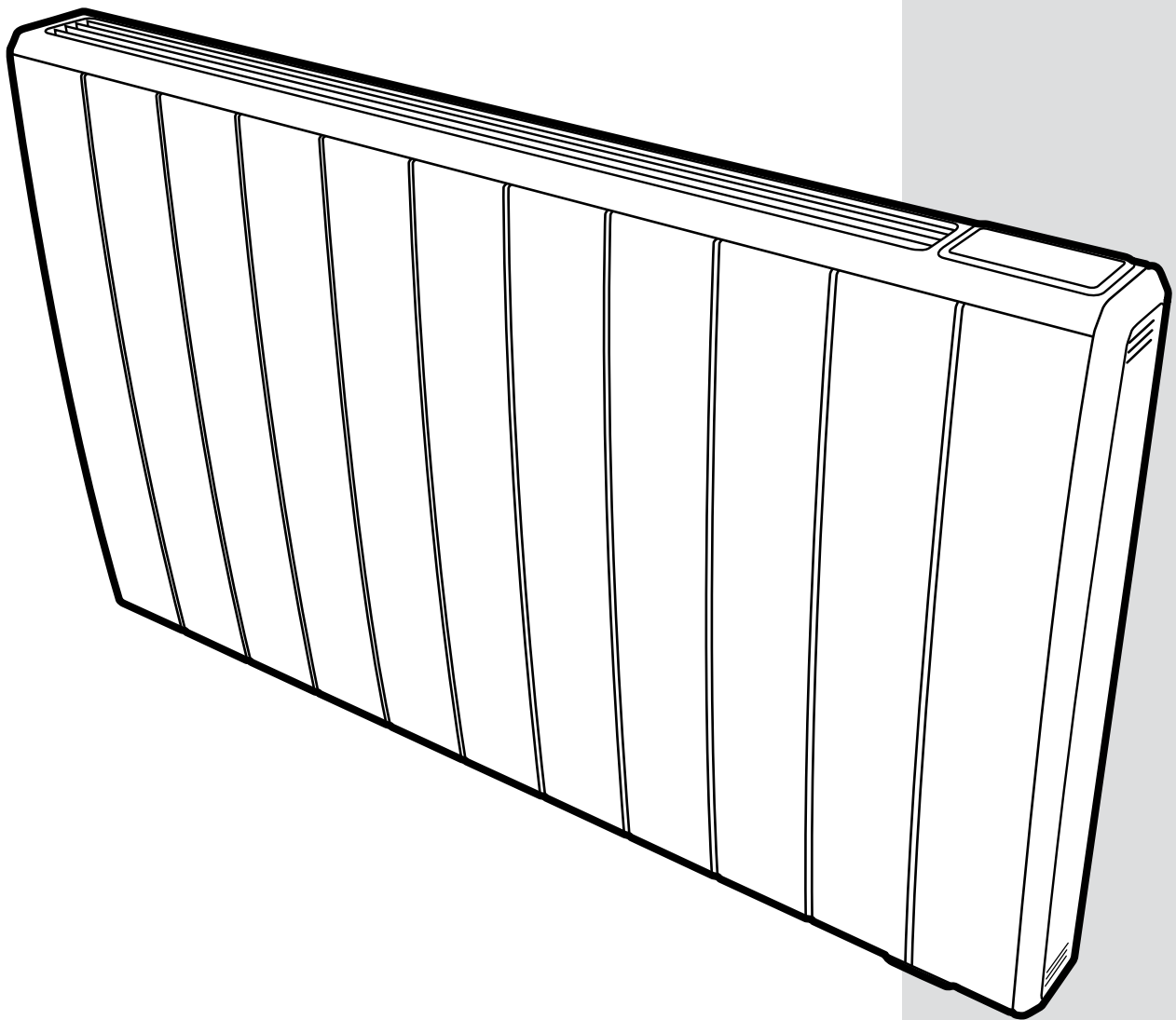

USER MANUAL FOR
WALL ELECTRIC
HEATERS **PLEASE
READ IT CAREFULLY
BEFORE OPERATING**

OPERATING INSTRUCTIONS MANUAL



Q-Rad Electric Radiator

Models: QRAD050 / QRAD075 / QRAD100 / QRAD15000

These instructions should be read carefully and retained for future use. Note also the information presented on the appliance.

Quick Start Guide

This guide is for quick reference only. Please refer to the operating section for further information.

How Does the Heater Control Work?

The control allows you to choose when you want heat and at what temperature.

When using a timer mode (see below), Comfort On will display on the home screen to tell you when the heater is maintaining the temperature displayed. Comfort Off will display when the heater is outside of a timed heating period.

When Manual, Eco or Frost modes are being used the heater will always maintain the temperature shown on the home screen.

Set the Time

To set the date and time on the heater, press Menu, then press the Enter with Time / Date highlighted. Press the arrow keys until the correct value is shown, then press Enter to confirm and move on to the next value. Repeat until all digits are correct, and Set displays, then press Back.

The time is automatically adjusted in spring and autumn between Greenwich Mean Time (GMT) and British Summer Time (BST).

Set the Temperature

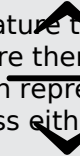
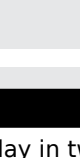
The temperature shown on the display is the room temperature set point. This is the temperature that the heater will maintain during heating periods. If the room temperature is above this temperature then the heater will not operate. The heater leaves the factory with this temperature set at 21°C which represents a typical, comfortable room temperature. If you require a different room temperature then press either  or  on the home screen until the display shows the temperature you require.

Timer Modes

Your Quantum heater comes pre-programmed with four time modes. These modes define the periods when the heater will operate in Comfort On mode. The four modes are:

Timer Mode	Description
Out All Day	6 hours heating per day in two periods
Home All Day	9 hours heating per day in one period
Holiday	Set the number of days for which you are on holiday
User Timer	Customise times in four periods

Child Lock

If you need to lock the controls so that the settings cannot be changed then activate the Child Lock. To lock the controls press and hold both the Back button and Enter for three seconds. Child Lock will appear at the bottom of the screen. To unlock the control repeat the action by pressing both the Back button and Enter for three seconds.

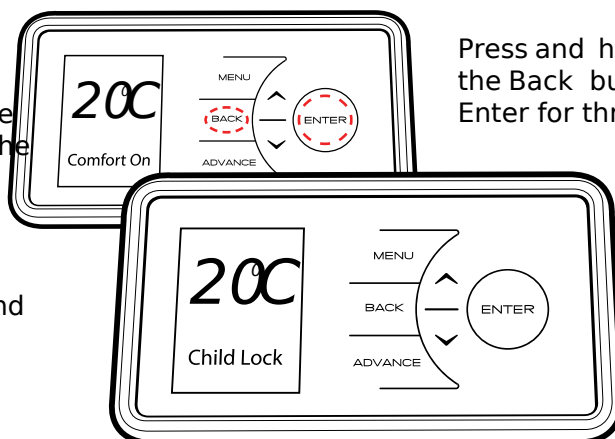

Press and hold both the Back button and Enter for three seconds

Which Timer Mode is Best for Me?

The heater leaves the factory set in Out All Day mode. If you are out during the day and only require heat in the mornings and evenings then this mode will suit your lifestyle and you won't need to alter anything. If you are in during the day then you should select the Home All Day mode which is a single heating period. The times of the modes can be modified, or the User Timer mode can be used to give you four periods of heating split throughout the day. If you are away for an extended period then you can use the Holiday mode. This allows you to reduce heating during the period that you are away, reverting to the previously selected mode on the day you return.

To choose a timer mode press Menu followed by Enter to select Mode then Timer Mode. Select the mode required by pressing \uparrow or \downarrow then Enter. For options Out All Day, Home All Day and User Timer, three choices are available - Select, Preview and Modify.

Select - Choose this timer option

Preview - View the times currently set

Modify - Change the times currently set

(Please refer to the operating section of this manual for information on how to modify the programmed times.)

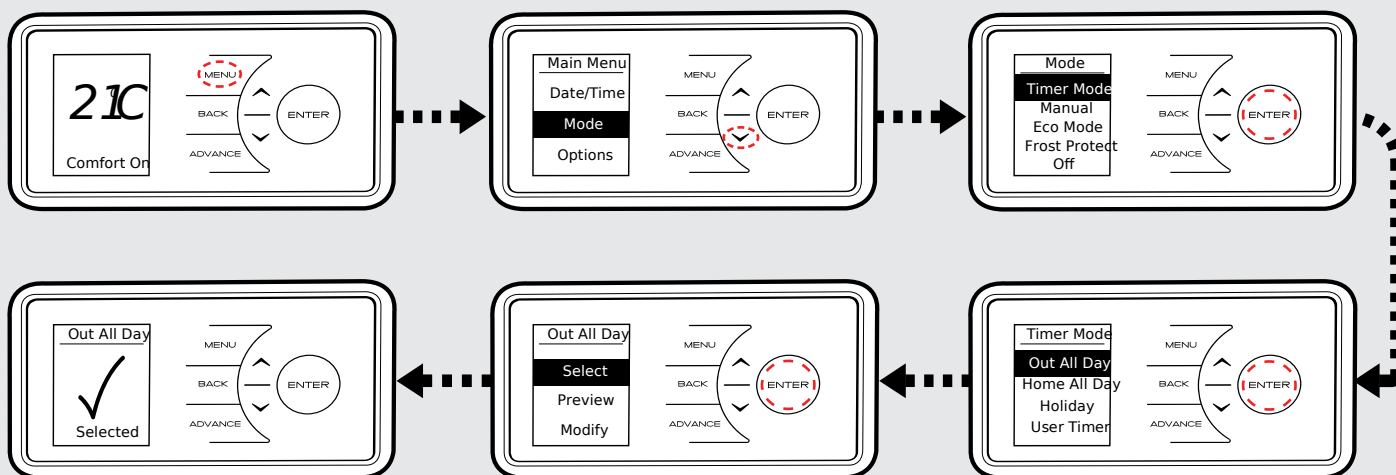

Advance

Sometimes you may be at home when you had not planned to be, or need to leave when you had planned to have the heating on. You can change the way you use your heating temporarily, this temporary change is achieved by using the Advance function.

When a timer has been selected, the Advance function allows you to begin the next Comfort On period early. If the heater is in a Comfort Off period and you want heat - press the Advance button. If the heater is in Comfort On and you don't want heat, press the Advance button and it will go off until the beginning of the next Comfort On period.

Advance Boost

The Advance button is also used to give a Boost which provides temporary heating for one, two, three or four hours. Press the Advance button twice to begin a one hour Boost. Continue pressing the Advance button to enter the longer Boost periods.

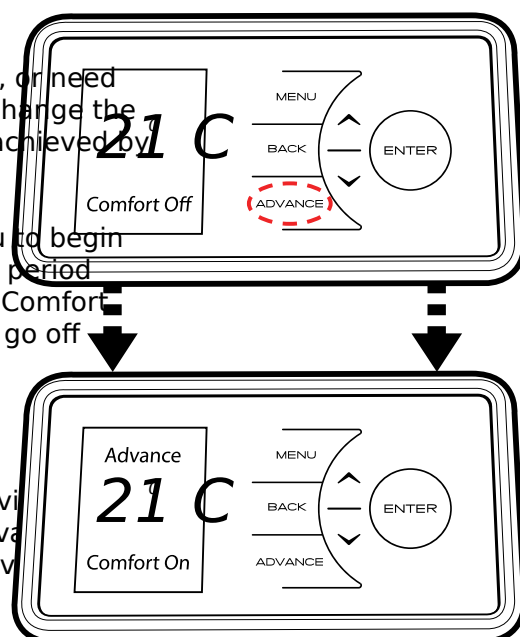

Operation

The controls are located on the top right of the heater. The heater is fitted with an adjustable electronic controller consisting of a display screen and six touch sensitive buttons.

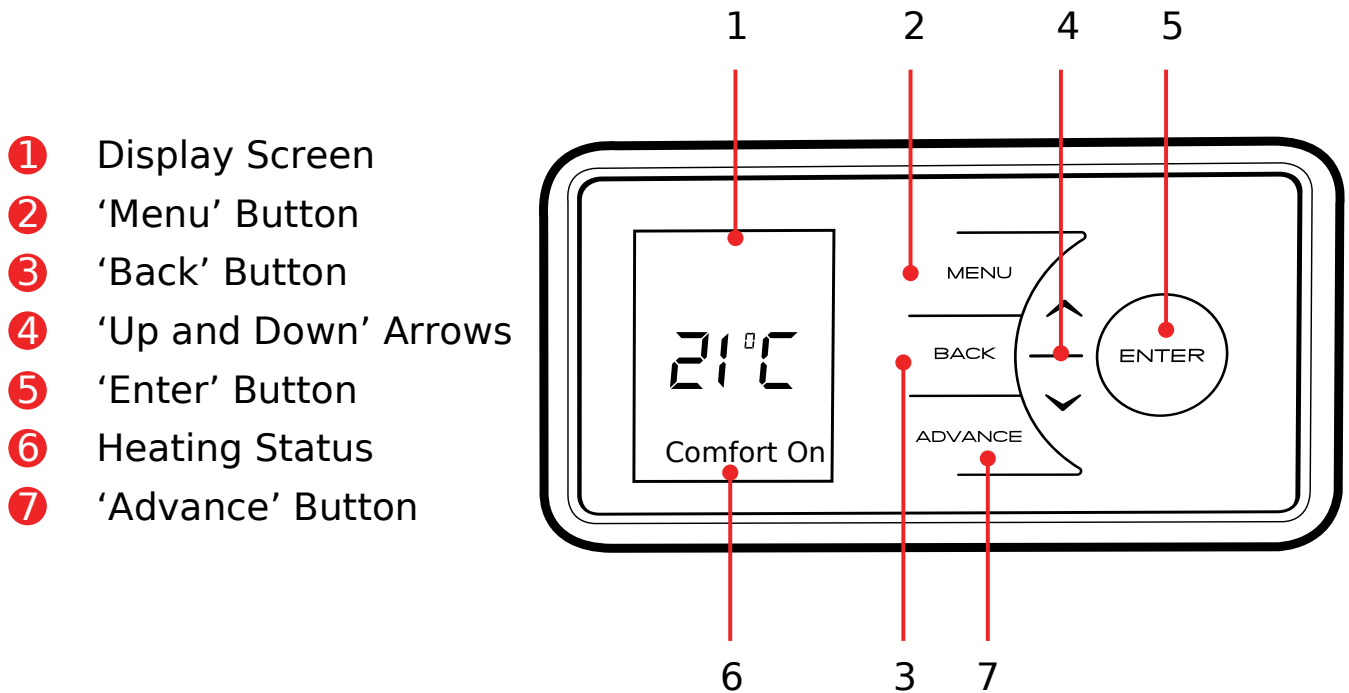

The heater is fitted with an adjustable thermostat enabling the room temperature to be controlled. The minimum room temperature is 7°C. The maximum temperature is set to 26°C by default however this can be increased to 32°C if required. A temperature of 21°C represents a normal room temperature.



NOTE: Should the heater fail to operate, this may be due to the room temperature being higher than the thermostat setting.



NOTE: Your heater may produce some noise during operation. This noise is caused by the expansion and contraction of the element as it changes temperature, and is normal for this type of product. Whilst the noise produced is usually very quiet, certain environmental factors can make it more noticeable, such as hard flooring or minimal furnishings.

Control Function

The heater controls can be easily adjusted by using the six buttons on the User Interface.

1. The Display Screen shows the options available at each stage of adjustment.
2. Menu – displays the main options list;
Date/Time – Set the date and time.
Mode – Set the mode of operation.
Options – Temperature units, daylight savings time, lock settings and service information.
3. Back returns to the previous programming stage.
4. The UP and DOWN buttons are used to navigate through the menus and alter setting values. The Up and Down button are also used to adjust the required room temperature on the main screen. The screen colour changes based on the temperature selected, showing deep blue through to bright red.
5. ENTER is used within the menu options to confirm settings. On the main screen pressing Enter will display the enabled features.
6. The timed periods during which the heater is providing heat are defined as 'Comfort On' (this is displayed at the bottom of the screen).

Outside of heating periods the heater will not deliver heat and these periods are called 'Comfort Off'.

While constant heat modes are active, the mode of operation is displayed at the bottom of the screen e.g. 'Manual'.

7. The ADVANCE button overrides the heating settings and changes the operational state of the heater. If a timer mode is active, pressing Advance will cause the heater to remain ON until the next OFF period is due, or OFF until the next ON period is due.

If the heater is in a constant mode of operation, Advance can be used to switch the appliance ON and OFF.

Advance is also used to enter Boost mode. Boost mode delivers heat for between one and four hours.

Main Screen

After 30 seconds of inactivity the heater will default back to the Main Screen. Here the chosen temperature is displayed along with the mode of operation. Any use of the Advance function will be displayed here, and pressing Enter will show the functions which are enabled.

When left inactive for a long period of time this display will 'sleep' and the temperature will disappear. Press any button for its return.

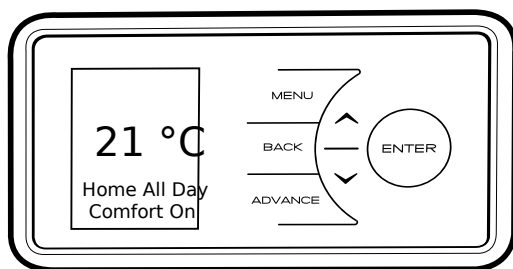

NOTE: The display screen will return to the main screen after a period of 30 seconds of inactivity.



NOTE: Pressing ENTER will show the functions which are enabled, e.g. ES and OW above. Ref: page 7.

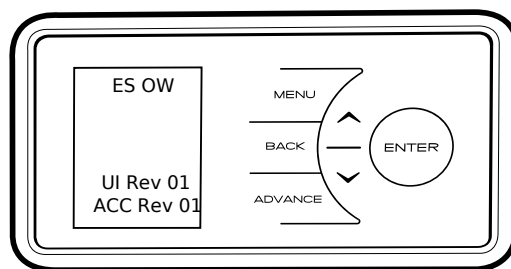

Setting the Date and Time

The heater incorporates a real time clock and calendar function. The time clock has a battery backup that will keep the clock running in the event of a mains power outage.

To adjust the time or date follow the steps below:

Press the Menu button. Select Date/Time by pressing the Enter button. Press \uparrow to select the correct day of the month and Enter to select.

Repeat this operation until the date and time has been set, ensuring to press Enter to select. Press Back button to return to the Main Screen once Set has been displayed.

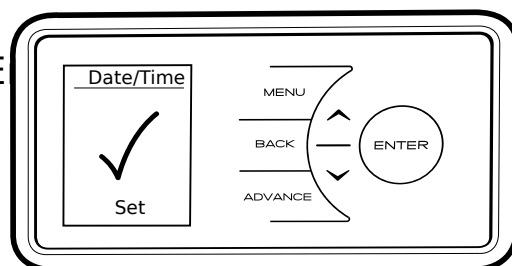
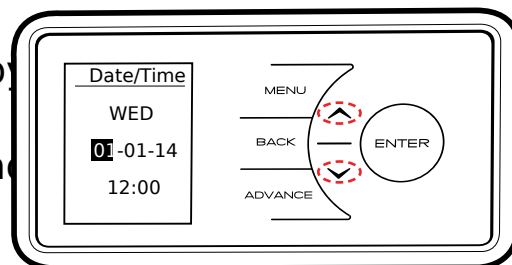
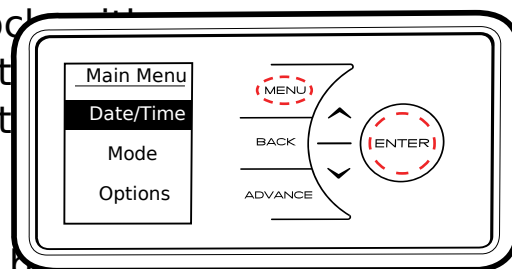

Modes of Operation

The heater comes pre-programmed with a set of heating profiles. There are four options available - three preset and one user adjustable timer;

1. Out All Day (pre-programmed) has the following preset times Monday to Sunday, which can be altered if desired;
07.00 until 08.30
17.30 until 22.00
2. Home All Day (pre-programmed) has the following preset times Monday to Sunday, which can be altered if desired;
08.00 until 21.00
3. Holiday (pre-programmed for 7 days at 10°C) - set the number of days required (from 1 to 300) and the temperature required. 7°C is advised if you just want to protect the property from frost while you are away.
4. User Timer - provides greatest flexibility to the user. Four time slots are available throughout the day and these can be customised for each day of the week.



NOTE: Once modified a programme must be selected if you want to begin using it.

The heater can also maintain a constant room temperature using the following modes;

1. Manual mode heats the room to a comfortable temperature of 21°C.
2. Eco mode maintains a room temperature of 18°C. By reducing the room temperature slightly, significant energy savings can be achieved. The green display colour indicates that selected temperature provides a comfortable room temperature while reducing energy consumption.
3. Frost Protect mode maintains a room temperature of 7°C. This mode should be used to provide protection against frost as indicated by the blue display.



NOTE: It is recommended that the timer is used as doing so can reduce the running cost. Operating the appliance in the permanent heating modes may result in increased running costs.

Select Off to switch off the appliance. This mode should be used when heating is not required for extended periods. Press any of the buttons to activate the display and then select the required mode of operation.



NOTE: In all modes and can be used to adjust the required room temperature. In timer modes, this change is temporary and the heater will revert the saved heating profiles at the end of Comfort On period.

Choosing and Setting a Mode

Timer Modes

To choose a timer mode press Menu and select Mode, then press Enter.

Now select Timer Mode, again using the Enter button. Select the mode required, by pressing the up and Enter buttons.

For options Out All Day, Home All Day and User Timer, three choices are available - Select, Preview and Modify.

- Select - choose this timer option.
- Preview - view the times currently set.
- Modify - change the times currently set.

When Modify is chosen, select and change each option using the up and Enter buttons. At the end of each period, select Next to move to the following period. When a day is complete select Save to update it.

Once the first day has been set up it is possible to copy these settings to successive days or all days by either choosing Copy Next or Copy All.

If preferred each day can be modified individually and saved. It is also possible to Clear each day or Clear All days. Options are;



- Save - save times for one day.
- Copy Next - copy times to following day.
- Copy All - copy times to all seven days.
- Clear - zero all times that day.
- Clear All - zero all times for all seven days.

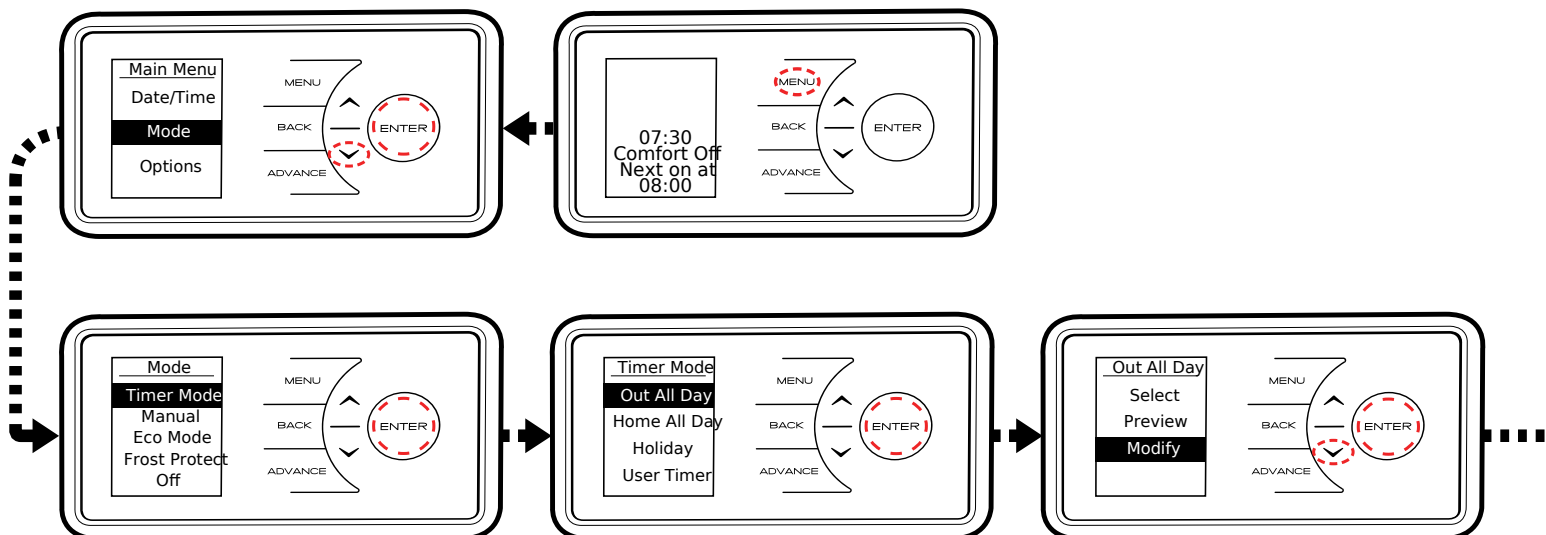

To select a mode, choose Select and press Enter.



If EcoStart control is disabled, the heater will not operate until the beginning of the heating period. This should be taken into consideration when setting the heating periods (See note below and page 17).

In Holiday mode the number of days that the room will be unoccupied can be adjusted together with the required room temperature.

Press  and  to choose a holiday period between 1 and 300 days, then press the Enter button.

Press  and  to choose a temperature to be maintained during this period and press the Enter button. At the end of the holiday mode the heater will automatically revert back to the previously selected programme.

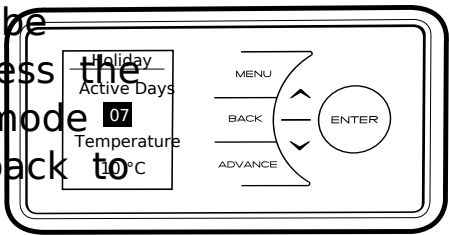

Constant Heat Modes

To choose a constant heat mode press  to select Mode and press Enter. Then select the required mode, again using the Enter button.



NOTE: If EcoStart (ES) is enabled the heater will begin heating the room before the start of the heating period to ensure the room is at the required temperature when the period starts. If disabled the heater will simply start heating at the start of the Comfort On period.

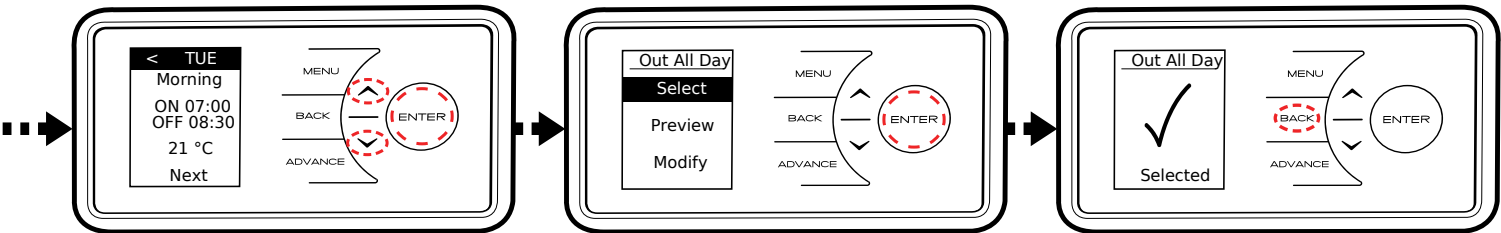

Advance

The Advance function allows the heating profile of the appliance to be changed temporarily. When a timer has been selected, the Advance function is used to begin the next Comfort On mode early. If the heater is in Comfort Off mode and heat is required, press the Advance button.

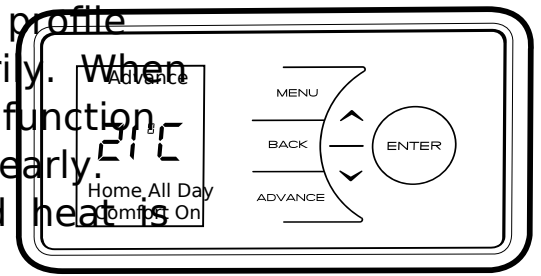

If the heater is in Comfort On and heat is not required, press the Advance button and the heater will turn off until the beginning of the next Comfort On period. If the heater is in Manual, Eco Mode or Frost Protect mode pressing the Advance button will switch off the heater. The heater will remain off until the Advance button is pressed again.

Boost

The Advance button is also used to enter the Boost mode which provides temporary heating for one, two, three or four hours. Press the Advance button twice to begin a one hour Boost. Continue pressing the Advance button to set longer Boost periods.

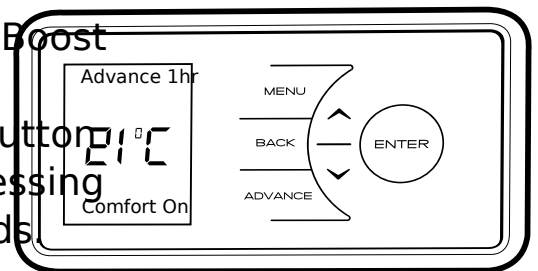

Options

The Options menu allows the settings to be modified to suit the user's requirements. These are;

DST Rule - Select your daylight saving setting. The heater clock will automatically adjust for daylight saving or "British Summer Time" as it is often referred to. If no adjustment is required then select none.

Auto Lock - Enable or disable the Auto Lock feature. This feature locks the interface if left inactive for longer than one minute. To unlock the appliance, press and hold the Advance button for two seconds.

Sound - Audio feedback can be enabled or disabled.

Service Info - Service information is displayed.

Temp Units - Choose whether your unit displays degrees centigrade or Fahrenheit.

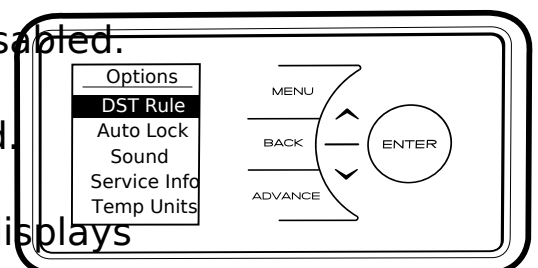

Child Lock

To lock the controls press Back and Enter for three seconds. Child Lock will appear at the bottom of the screen. To unlock the control repeat the action pressing Back and Enter for three seconds.



NOTE: The controls cannot be adjusted when child lock is active.

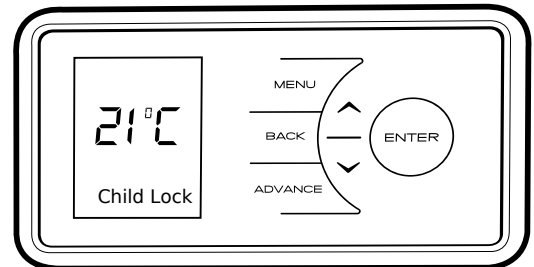

User Information

Press and hold Enter for five seconds to display the User Information menu;

SP Range (set point) allows adjustment of the maximum temperature.

Open Window detection (OW). When enabled the appliance will reduce the target room temperature to limit the energy wasted when a window is open.

Occupancy detection (OD) reduces the room temperature when the room is unoccupied. Note: currently not available on this model.

EcoStart (ES) – to achieve the desired temperature at the onset of the timed Comfort On period the appliance anticipates when it needs to start heating prior to the onset of the timed 'on' period. E.g. room is 16°C, with 21°C at 7am set on the timer. With ES on the control will start to heat the room before 7am reaching 21°C at this time. With ES off the heater will start to heat the room at 7am and will reach 21°C after this time.

Factory reset returns all settings to the factory presets.



NOTE: Open Window detection is enabled by default. EcoStart is disabled by default.

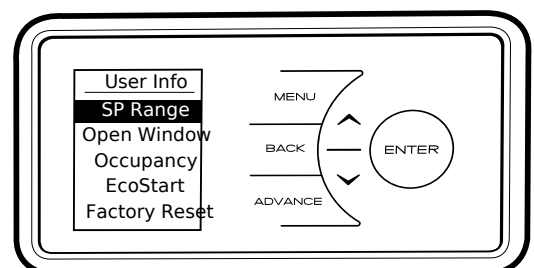

Energy Saving Tips

The energy we use to heat, light and power our homes contributes over a quarter of the UK's carbon emissions, the principle contributor to climate change.

Around half the energy used in the home is for heating and hot water, so using your heating system efficiently will not only help the environment, but also save you money.

Energy efficiency tips for heating and hot water

1. Don't set the temperature too high...

Reducing the thermostat setting by just 1°C can reduce your energy use by as much as 10%. If you're going away during the winter, leave the thermostat on the frost protection setting to provide protection from freezing at minimum cost.

2. Use it where you need it...

Set the appropriate temperature on your heaters for the room they are in; for example, leave the thermostat on a heater in a spare bedroom on a lower setting.

3. Use it when you need it...

Use heaters fitted with timers or linked to central controllers to turn the heating on only when you need it and automatically switch it off when you don't.

4. Curtains

Close your curtains at dusk to stop heat escaping through the windows.

5. Windows

Nearly 25% of heat loss can occur through poorly insulated frames and single glazing. If you can't afford to double glaze all your windows, go for the rooms you heat most.

6. Treat your hot water tank...

Give it a jacket. An insulating jacket for water tanks costs only a few pounds and pays for itself within months. Fit one that's at least 75mm (3") thick and you could save £10-15 a year.

7. Water

Use a shower if you have one to save money and water. Don't set the thermostat too high on your water heater - 60°C/140°F is usually adequate for bathing and washing. Put the plug in when running hot water in your sink - leaving hot taps running is wasteful and expensive. Ensure dripping taps are repaired quickly. In just one day, you could waste enough water to fill a bath.

Other energy saving tips for around the home

1. Lights

Turn off lights whenever you leave a room for more than ten minutes. Use low energy bulbs wherever you can as they use less than a quarter of the electricity used by ordinary light bulbs and last ten times longer!

2. Cooking

Use the right size pan for food and cook on a low hob. Keep saucepan lids on - this enables you to turn down the heat. Boil water for cooking a kettle first.

Important

During the initial operation, some odour may be noticed due to the newness of materials used in manufacture. This is normal and disappears after a short period of use. It is however advisable to keep the room well ventilated.

Cleaning

WARNING- ALWAYS DISCONNECT FROM THE POWER SUPPLY BEFORE CLEANING THE HEATER.

Before commencing cleaning, disconnect the electricity supply to the appliance and allow it to cool. The outside can be cleaned by wiping it over with a soft damp cloth and then dried. Do not use abrasive cleaning powders or furniture polish, as this can damage the surface finish.

To release the heater from the wall bracket for cleaning or redecoration, depress the latch on both brackets (See Fig. 3, page 5) and slide forward.

Recycling

For electrical products sold within the European Community at the end of the electrical products useful life it should not be disposed of with household waste. Please recycle where facilities exist. Check with a Local Authority or retailer for recycling advice in your country.



After Sales Service

If this product appears damaged when first received or does not function correctly contact us by e-mail at aftersales@dimplex.co.uk or call 0844 879 3588. For ROI please call 01 842 8222.

Do not return the product in the first instance as this may delay us providing you with a satisfactory service. ACCIDENTAL DAMAGE IS NOT COVERED UNDER THE WARRANTY.

The product is guaranteed for two years from the date of purchase. Within this period we will take to repair or exchange this product free of charge provided it has been installed and operated in accordance with these instructions.

Should you require assistance with this product please go to www.dimplex.co.uk and click on "Customer Support" or e-mail us at aftersales@dimplex.co.uk

Alternatively call our contact centre on 0844 879 3588 (UK only). This is a Lo-call number from a BT Landline - other providers including mobile phones may charge you more. For ROI please call 01 842 8222.

To assist you, we need the following information: model number and product ID (these are found on the back of the appliance), nature of the fault and date of purchase. Please retain your receipt as proof of purchase. Your rights under this guarantee are additional to your statutory rights, which in turn are not affected by this guarantee.